

TM Site:

Description:

15-960NS

MOUNTAIN HWY. AT ROUTE 1 IN NORTH VANCOUVER

Station: 50380S

Survey: 5038

▲ - Short Count Post

□ - TRADAS Traffic Measurement Site

■ - Loops

① - Channels

■ - Junction Box

A - Detectors

PHOTOLOG

YEAR: -

HIGHWAY: -

IMAGE NUMBER: -

SHOWS LOOPS: -

YES

NO

GPS: N 49° 18'32.4"

W 123° 1'40.1"

± 200 metres

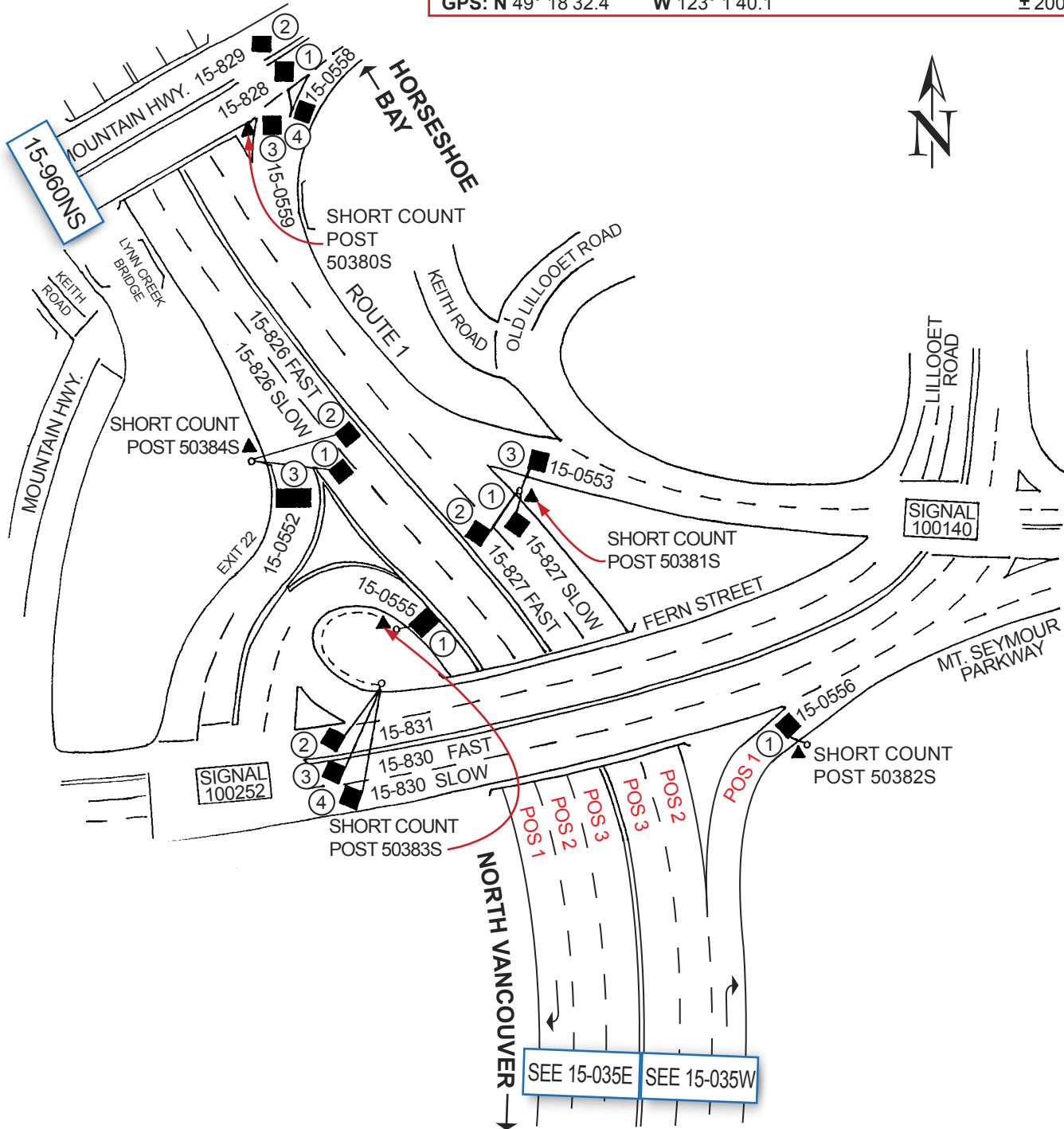

NOT TO SCALE

Highway Planning Branch
TRANHighway Planning@gov.bc.ca

Revised Date: May / 2007
Version 1-A